

Wiring Diagram

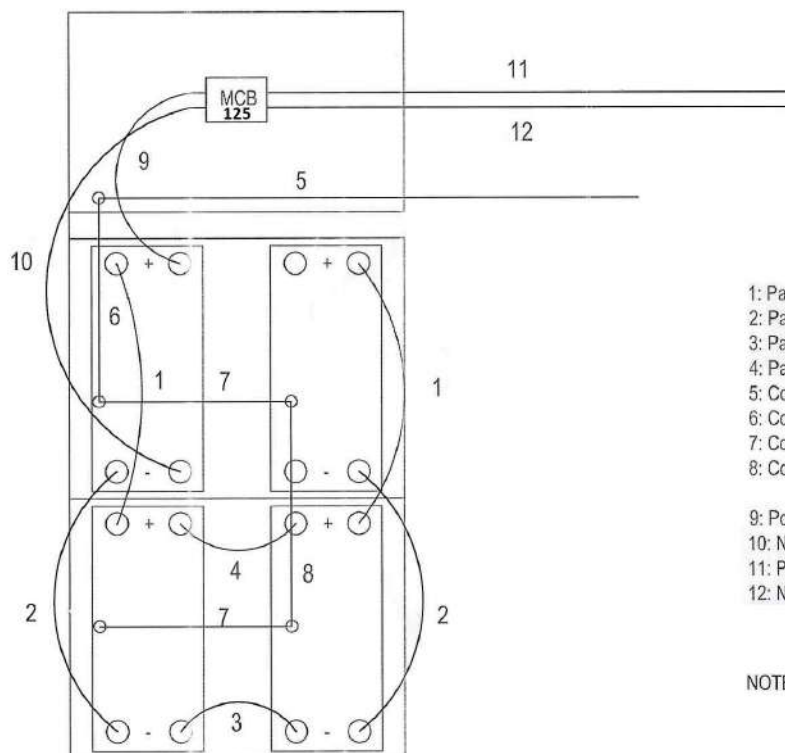

- 1: Parallel cable 1 (Positive power cable)*2pcs
- 2: Parallel cable 2 (Negative power cable)*2pcs
- 3: Parallel cable 3 (Positive power cable)*1pc
- 4: Parallel cable 4 (Negative power cable)*1pc
- 5: Communication cable 1 (Cabinet-inverter)*1pc
- 6: Communication cable 2 (Battery-cabinet)*1pc
- 7: Communication cable 3 (Battery-battery)*2pcs
- 8: Communication cable 4 (Battery-battery)*1pc

- 9: Positive power cable (Cabinet-battery)*1pc
- 10: Negative power cable (Cabinet-battery)*1pc
- 11: Positive power cable (Cabinet-inverter)*1pc
- 12: Negative power cable (Cabinet-inverter)*1pc

NOTE : 9-12 cables are fixed in the cabinet and not included in the cable kit.

Cable Kit Packing List				
NO.	NAME	SPECIFICATION	QTY	NOTES
1	Parallel Cable 1	700mm, 25mm ² , positive parallel power cable, battery-battery (Mark: Parallel cable 1)	2pcs	
2	Parallel Cable 2	650mm, 25mm ² , negative parallel power cable, battery-battery (Mark: Parallel cable 2)	2pcs	
3	Parallel Cable 3	235mm, 25mm ² , positive parallel power cable, battery-battery (Mark: Parallel cable 3)	1pc	
4	Parallel Cable 4	235mm, 25mm ² , parallel cable 4, negative cable, battery-battery (Mark: Parallel cable 4)	1pc	
5	Communication Cable 1	2m, cabinet-inverter (CAN communication) (Mark: INV/COM-BAT/COM)	1pc	
6	Communication Cable 2	400mm, pin-pin, battery- cabinet (Mark:COM)	1pc	
7	Communication Cable 3	200mm, pin-pin, battery-battery (Mark:A)	2pcs	
8	Communication Cable 4	650mm, pin-pin, battery-battery (Mark:B)	1pc	
9	Cable clip	Black, plastic, cable clip	4pcs	
10	Cable tie	4*200, nylon cable ties	20pcs	
11	Copper Lug	S25-8	4pcs	
12	120Ω Resistor	120Ω, one port of RJ45	2pcs	1pc: spare part